

Mahanalua Nui Subdivision Phase IV General Information Map (not to scale)

Additional Streambed Easement Area

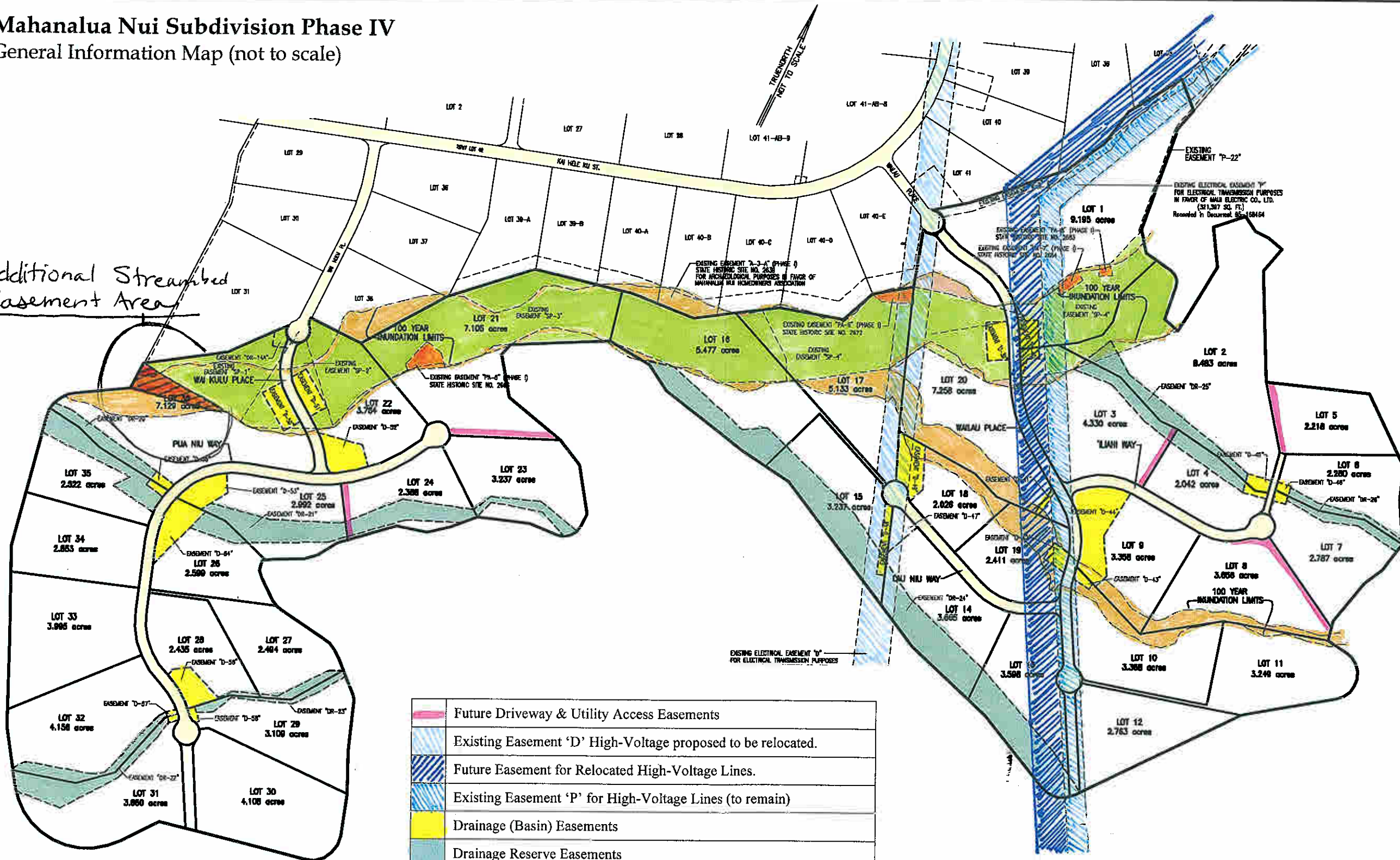

	Future Driveway & Utility Access Easements
	Existing Easement 'D' High-Voltage proposed to be relocated.
	Future Easement for Relocated High-Voltage Lines.
	Existing Easement 'P' for High-Voltage Lines (to remain)
	Drainage (Basin) Easements
	Drainage Reserve Easements
	Archeological Preservation Sites
	Streambed Park & Archeological Preserve
	100 Year Flood Inundation Boundary

Note: MAP IS NOT TO SCALE. The intent of the map is to show the general locations and sizes of lots, as well as existing and proposed easements and encumbrances affecting the lots.